

Leilighet A  
BTA 73,0 m<sup>2</sup>  
BRA 68,0 m<sup>2</sup>

Leilighet B  
BTA 72,0 m<sup>2</sup>  
BRA 67,0 m<sup>2</sup>

Leilighet C  
BTA 72,0 m<sup>2</sup>  
BRA 67,0 m<sup>2</sup>

Leilighet D  
BTA 72,0 m<sup>2</sup>  
BRA 67,0 m<sup>2</sup>

Leilighet E  
BTA 72,0 m<sup>2</sup>  
BRA 67,0 m<sup>2</sup>

Leilighet F  
BTA 73,0 m<sup>2</sup>  
BRA 68,0 m<sup>2</sup>

1996

Dato:	Tegnet:	Godkjent:	Målestokk:	Gnr:	Bnr:
			1: 125		
Henvisning:			Beregning:	Erstatning for:	Erstattet av:

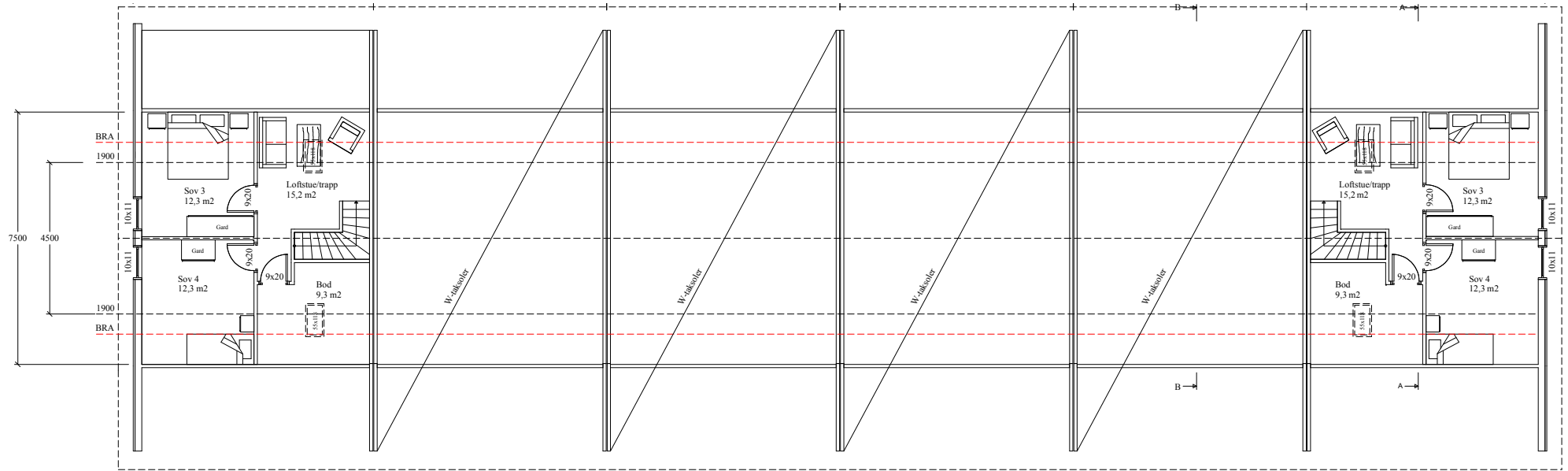

Lofteetasje Liiighet A  
 BTA 50 m²  
 BRA 39 M²

Lofteetasje Liiighet F  
 BTA 50 m²  
 BRA 39 M²

Dato:	Tegnet:	Godkjent:	Målestokk: 1: 100	Gnr:	Bnr:
Loftplan				Erstatning for:	Erstattet av:
Henvisning:		Beregning:			